

Self-Drilling Toggle Anchors Catalog Pg. 7

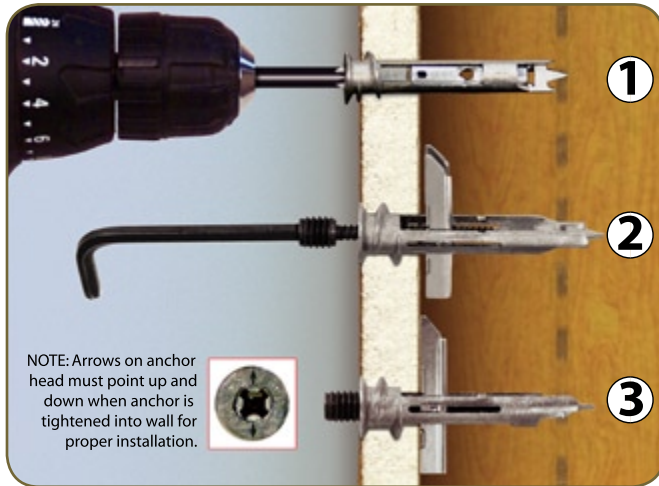

(1) Self-Drilling Toggle Anchors HD-ASTB, ASTBA & TA all install the same way. Measure and mark the locations for the anchors. Using a Phillips Bit, self-drill the anchors into position. NOTE: These anchors are not intended for wood or other dense materials.

(2) Insert the Flat Washer Head Screw with your system part or, the Combination Screw (shown), in the toggle and tighten. As it's tightened, the toggle lever automatically flips open to become a nut inside the wall.

(3) When fully tightened, the Combination Screw provides a 5/16-18 mounting stud. If a Flat Washer Head screw is used, the StandoffSystems™ parts you are attaching will be secured at the same time the screw is tightened.