

T-Nuts Catalog Catalog Pg. 9

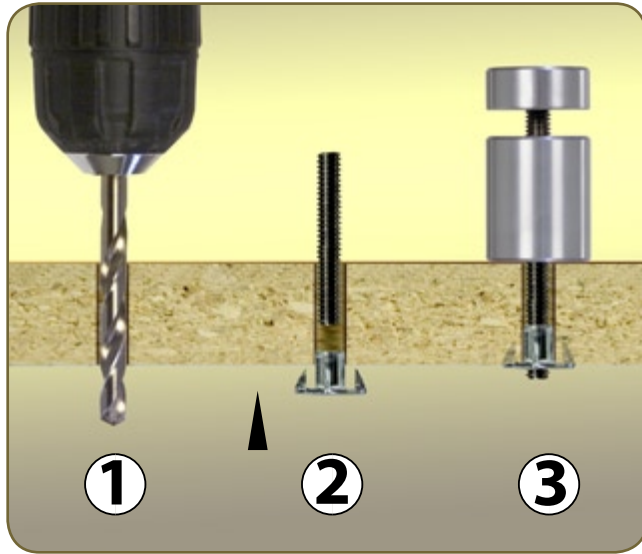

(1) Pre-drill wallboard or mounting surface to the proper hole size from the chart below. NOTE: T-Nuts require installation into the back side of your mounting surface and won't work in a 'blind' hole like some other hardware.

(2) Seat the T-Nut into it's hole with a hammer (black arrow). NOTE: It is important to drive the T-Nut till it is fully seated to prevent it's falling out or spinning when hardware is attached during final assembly.

(3) When you're ready to install your parts, thread the right size stud into the T-Nut being sure to fully engage all the threads in the T-Nut so that the stud or screw goes all the way through the nut. Attach the StandOff Systems™ parts for your application and tighten.

T-Nut Drill Size & Depth

Part	Thread	Drill Size	Depth
HD-WTN1	10-24	1/4"	3/8"
HD-WTN2	1/4-20	5/16"	7/16"
HD-WTN3	5/16-18	3/8"	7/16"
HD-WTN4	5/16-18	3/8"	11/16"