

Zip-Toggle Catalog Pg. 8

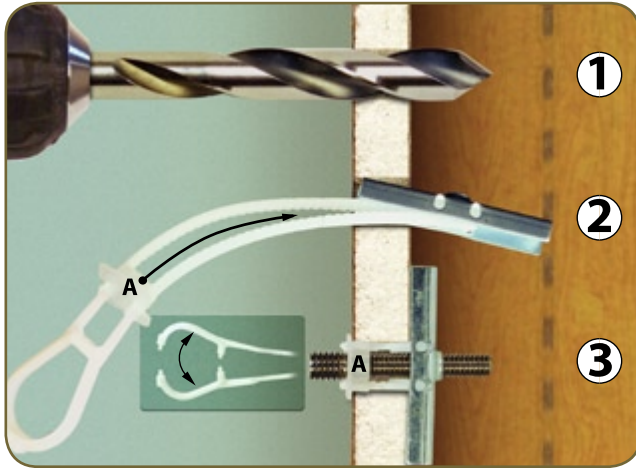

(1) Pre-drill wallboard or mounting surface with a 1/2" bit.

(2) Push the Zip-Toggle through the hole as shown. When the toggle flips back into the open position, push the lock ring (A) up tight against the wall while pulling the loop straight away from the wall. Once the assembly is tight on the wall, pull the loop apart (it is split), and bend the zippers to the wall to break them off.

(3) Screw the appropriate stud for your application and you're ready to attach your StandOff Systems™ parts.