

HD-NS1/2/3 Nut Inserts & Tool

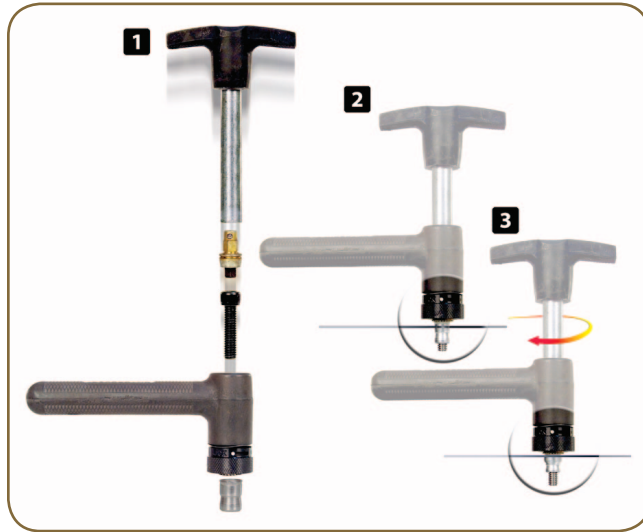

Nut Insert Drill Chart

Part	Thread	Drill Size
HD-NS1	10-24	9/32"
HD-NS2	1/4-20	3/8"
HD-NS3	5/16-18	1/2"
HD-ANTOOL1	10-24	9/32"
HD-ANTOOL2	1/4-20	3/8"
HD-ANTOOL3	5/16-18	1/2"

(1) Pre-drill the sheet metal or thin plastic using the recommended drill size chart below. Be sure to drill a straight hole and do not ream out the hole. The effectiveness of the nut insert is dependent on a snug fit.

Assemble the two-piece tool kit assembly (see diagram #1).

TIP: It helps the assembly if you lightly oil the threads on the long hex screw but be sure not to oil the outside of the nut insert.

(2) Place the nut insert into the pre-drilled hole in wall surface. Be sure the serrated groove end is on the face of the wall surface. Thread the tool into the nut insert.

(3) Turn the t-handle clockwise, which will then crush the nut insert on the backside of the wall surface. Be sure to keep the tool straight to ensure proper installation. Make sure to fully crush the nut insert with the tool. *TIP: You can use a 1/4" ratchet in the top of the t-handle if you need additional torque to crush the nut.*

Once installed, remove the t-handle, unscrew the black hex cap screw and remove the tool. Thread the proper threaded hardware into the nut insert and attach the appropriate **Gyford StandOff Systems®** parts for your application.

IMPORTANT

These HOW TO instructions are GUIDELINES ONLY. Your installation may be different from those shown here. NO SAFETY GUARANTEE is expressed or implied in any installation unless such guarantee is provided IN WRITING by Gyford Productions on installations that Gyford Productions does. It is the responsibility of the INSTALLER and/or END USER to ensure that the parts and materials used in any installation are specified and engineered to meet the demands of their intended purpose.

Call 775.829.7272 to speak with our knowledgeable Client Solutions Specialists about your installation.