

HD-WI1/2/3 Threaded Wood Inserts

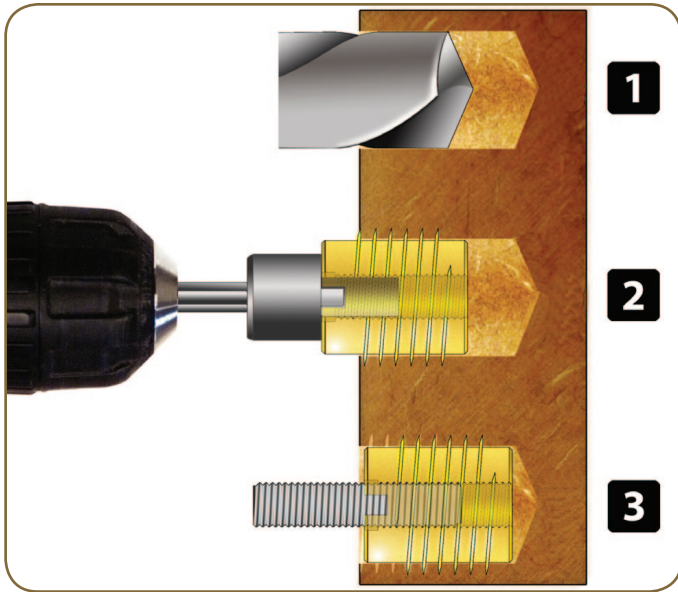

(1) Pre-drill mounting surface to the proper hole size from the chart below. For proper assembly, drill the hole just deep enough for the insert to seat with its top just slightly below the mounting surface. NOTE: *Drilling deeper will not add any strength to your installation.*

(2) Use the correct Wood Insert Driver (from the chart below) to install the insert into the wood. If only a few need to be installed, they can be successfully seated with a large, flat bladed screwdriver. Make sure it fits the insert slot properly so it will not slip and damage the internal threads or wall surface.

(3) Thread the proper threaded hardware and attach the appropriate Gyford StandOff Systems® parts for your application.

Wood Inserts Drill Sizes

Part	Thread	Length	Drill Size	Driver
HD-WI1	10-24	1/2"	3/8"	HD-WID1
HD-WI2	1/4-20	1/2"	3/8"	HD-WID2
HD-WI3	5/16-18	5/8"	1/2"	HD-WID3

IMPORTANT

These HOW TO instructions are GUIDELINES ONLY. Your installation may be different from those shown here. NO SAFETY GUARANTEE is expressed or implied in any installation unless such guarantee is provided IN WRITING by Gyford Productions on installations that Gyford Productions does. It is the responsibility of the INSTALLER and/or END USER to ensure that the parts and materials used in any installation are specified and engineered to meet the demands of their intended purpose.

Call 775.829.7272 to speak with our knowledgeable Client Solutions Specialists about your installation.