

Wood Mount Hanger Screws

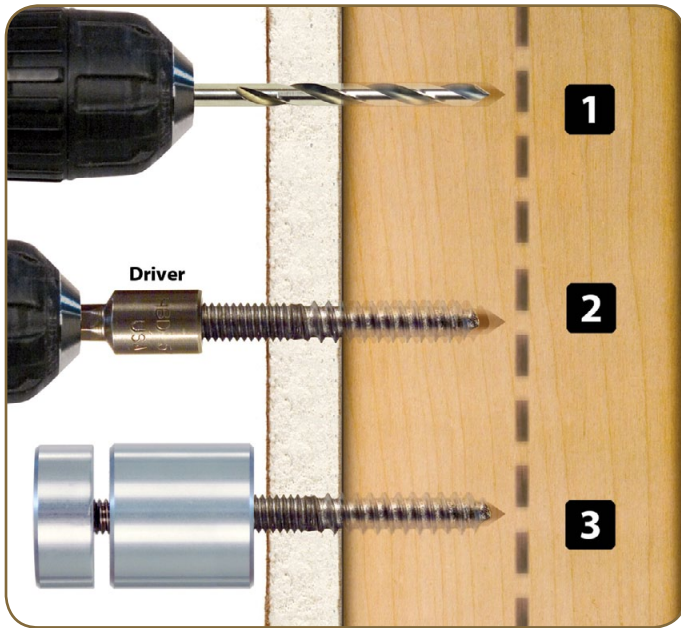

Wood Mount Hanger Screws Drill Size

Part	Thread x Length	Overall Length	Pre-drill
HD-WHS0	6-32 x 3/4"	1-3/8"	1/16"
HD-WHS1	10-24 x 5/8"	1-1/2"	1/8"
HD-WHS2	1/4-20 x 1"	2-3/16"	3/16"
HD-WHS3	5/16-18 x 9/16"	1-1/2"	1/4"
HD-WHS4	5/16-18 x 1"	2-1/2"	1/4"
HD-WHS5	5/16-18 x 2"	4-1/4"	1/4"
HD-WHSD0	Driver for 6-32 size		
HD-WHSD1	Driver for 10-24 size		
HD-WHSD2	Driver for 5/16-18 size		
HD-WHSD3	Driver for 1/4-20 size		

(1) Pre-drill the proper pilot hole size into wood surface using the chart above.

(2) To install the hanger screw, we recommend two options:

Option A: If only a few need to be installed, we recommend using two hex jam nuts to use as a tool to wrench and tighten into surface.

Option B: Purchase a stud driver for the correct thread size using the chart below. *TIP: Apply candle wax or bar of soap onto anchor to help with installing and/or removing it from wall surface.* Be sure to leave the desired thread length exposed from the wall surface needed to attach parts. Once installed, Remove the hex jam nuts or driver from anchor.

(3) Attach the appropriate **Gyford StandOff Systems®** parts for your application.

IMPORTANT

These HOW TO instructions are GUIDELINES ONLY. Your installation may be different from those shown here. NO SAFETY GUARANTEE is expressed or implied in any installation unless such guarantee is provided IN WRITING by Gyford Productions on installations that Gyford Productions does. It is the responsibility of the INSTALLER and/or END USER to ensure that the parts and materials used in any installation are specified and engineered to meet the demands of their intended purpose.

Call 775.829.7272 to speak with our knowledgeable Client Solutions Specialists about your installation.